

Dial Support wood 10 mm thick
2 Required Scale 1:1

Dial Support can be glued to the back of the frame to stop the motor rotating. It can be Glued to the Back of the Dial at the bottom to help the Dial stand up at 90 degrees to the base

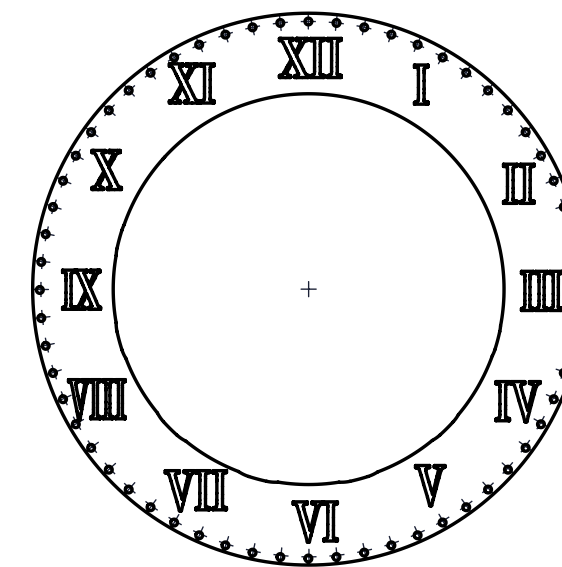
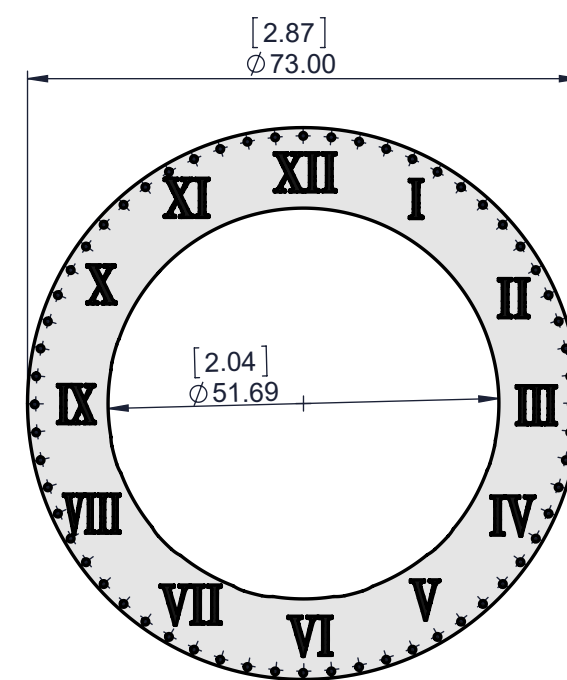

DIALS TO BE PRINTED ON SHINY CARD
EITHER MAY BE PRINTED TO SCALE
AND GLUED TO THE CLOCK FACE

Motor to be Purchased with these approximate dimensions.
It must have M4 thread on the end of the shaft

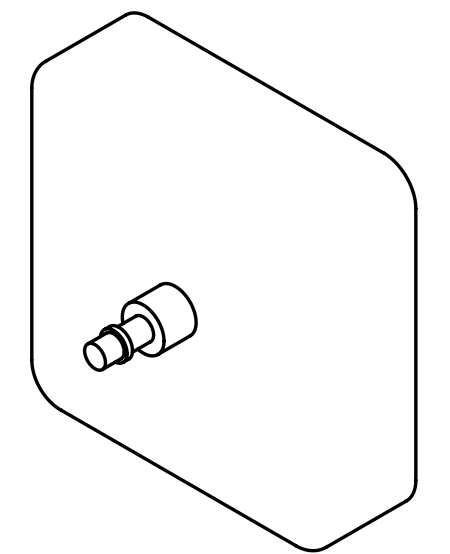
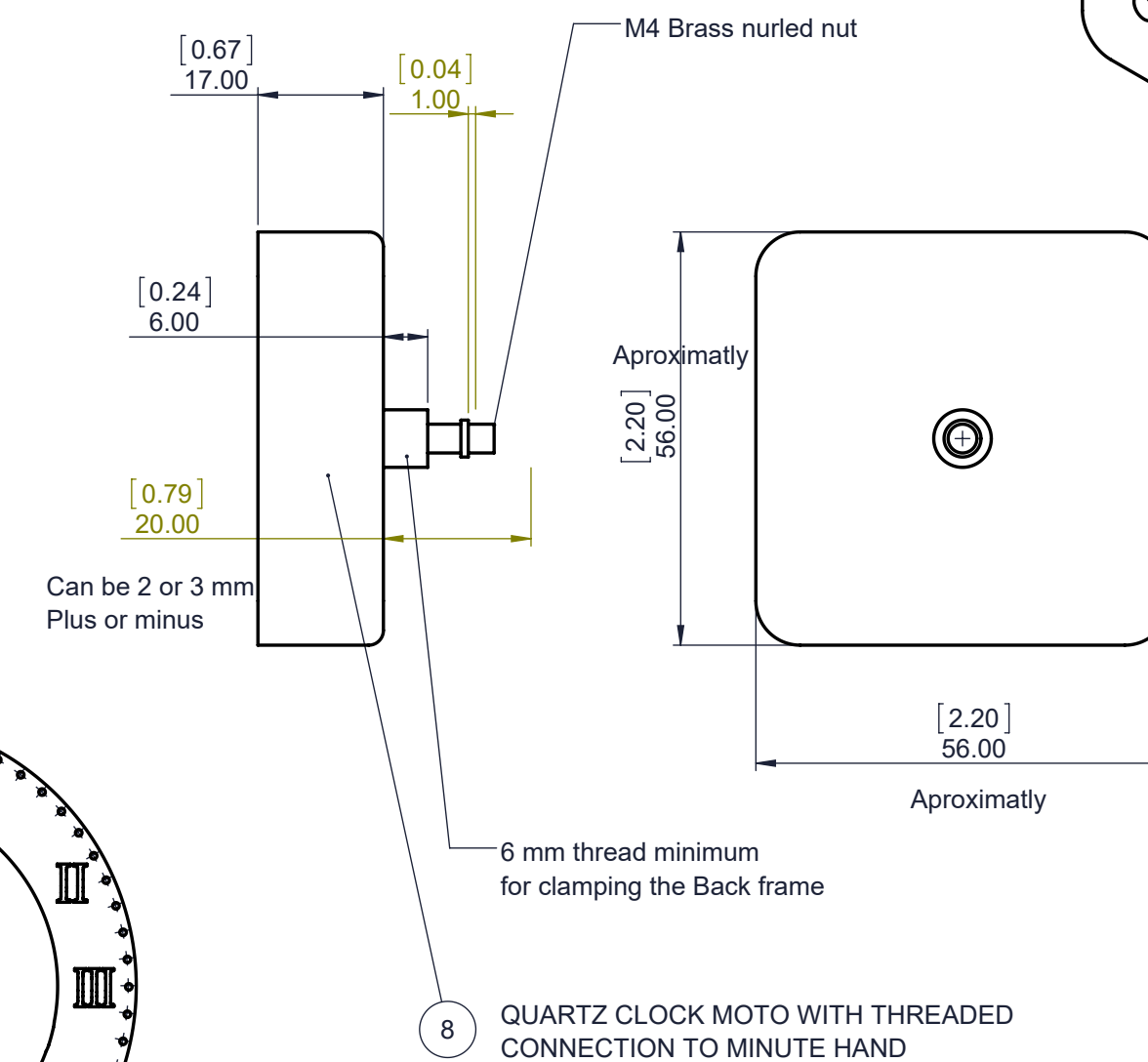

Sht 3 of 4 Shts	A2	Clock 59 - Quartz Driven Clock	
Not to Scale Unless otherwise stated		All dimensions in mm and (inches) 3rd Angle projection	Designed by: Brian law November 2024 www.woodenclocks.co.uk

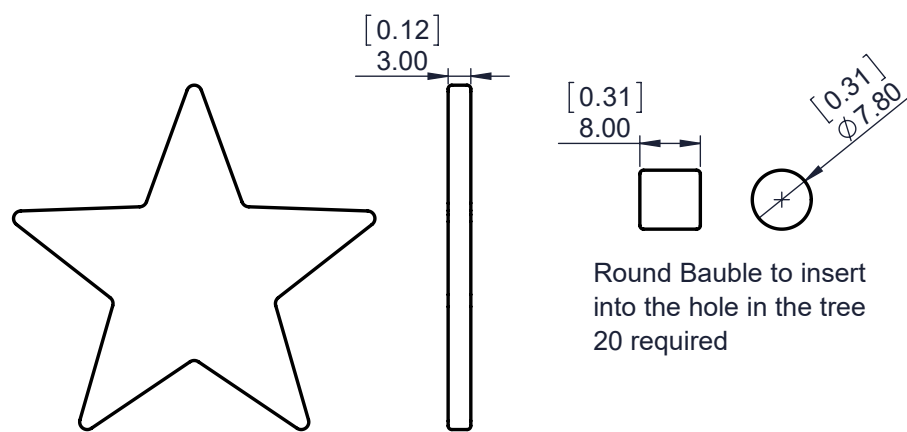

Round Bauble to insert into the hole in the tree 20 required

Star for the top of the tree to be glued on directly to the top of the tree

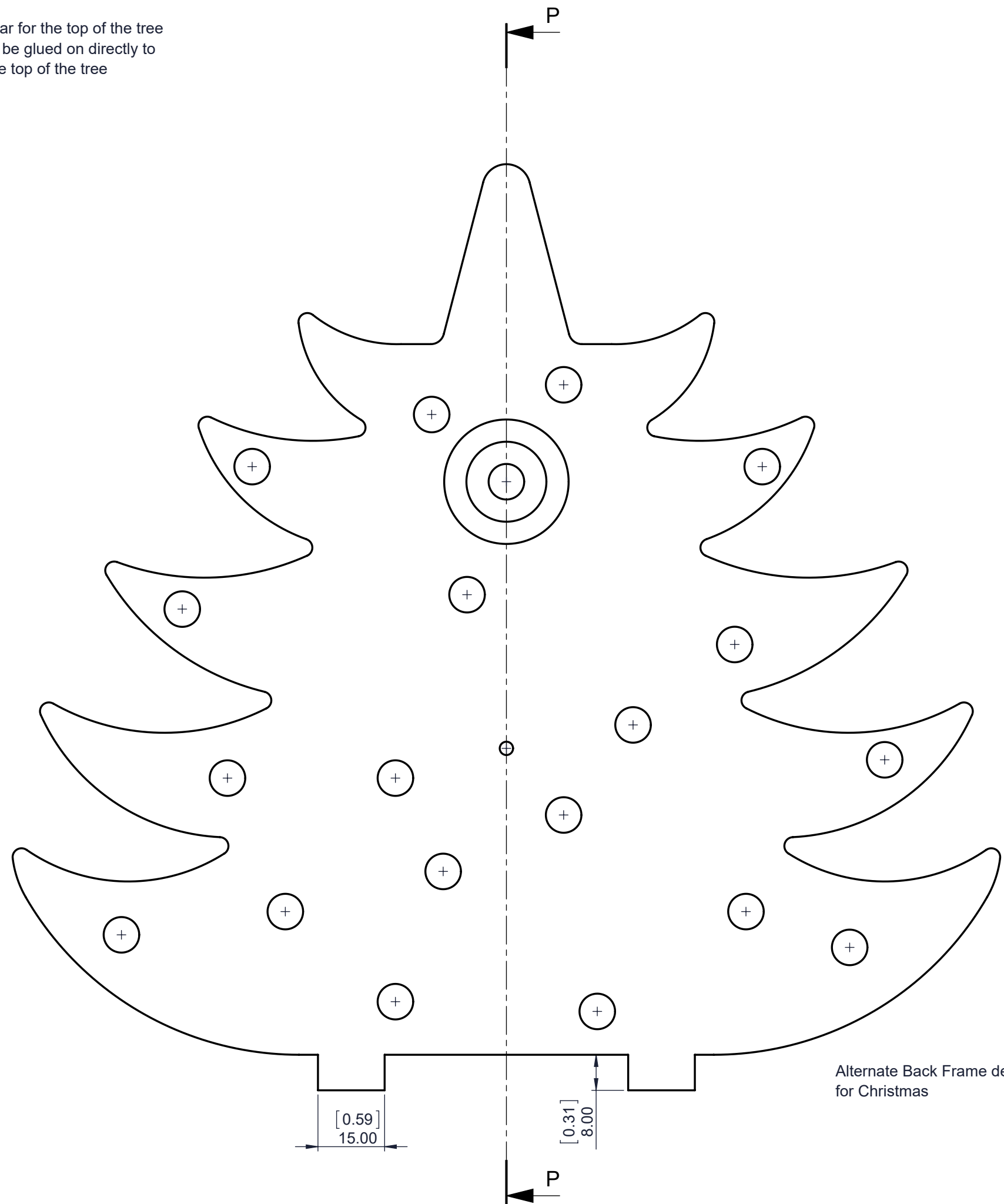

Alternate Back Frame design for Christmas

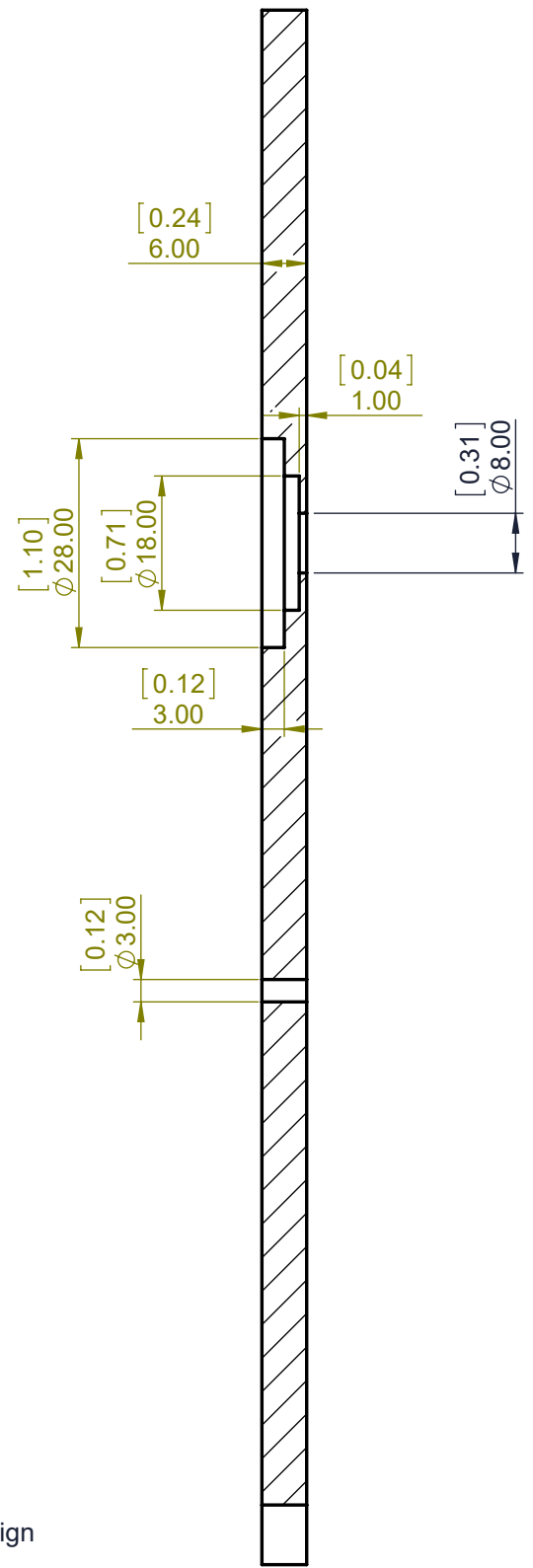

SECTION P-P



Sht 4 of 4 Shts	A2	Clock 59 - Quartz Driven Clock	
Not to Scale Unless otherwise stated		All dimensions in mm and (inches) 3rd Angle projection	Designed by: Brian law November 2024 www.woodenclocks.co.uk